



FURNITUBES

linxRAILING™



For years, the technology surrounding guardrail systems has remained unchanged.

In response to increased demand for safety on the highway, Furnitubes have designed and developed the new patented Linx railing system - an astonishing, simple revolution in guardrail design and installation.

The Linx system:

- utilises standard components
- doesn't require radiused panels
- requires minimal site survey
- suitable for almost every site
- available in a range of options
- 100% recyclable



• straight runs



• gradients



• bends, corners



• & all combinations

www.furnitubes.com



linxRAILING™ explained

Those involved in specifying and installing guardrail are all too aware of the inflexibility of most systems. The necessity for a full site survey and the manufacture of 'special' components and 'one-offs' to suit specific site conditions is time-consuming and expensive. Furthermore, if replacement sections are required after an accident has occurred, the exact damaged components need to be identified and new 'special' components manufactured. This inevitably results in the site being left in disrepair for a long period of time.

Furnitubes are now able to offer the complete solution with the Linx railing system. The unique, patented post-to-panel connections of the Linx enables standard straight panels to be adjusted in angle and height on site, to suit a variety of curves, bends, junctions and levels.

It's so simple it's brilliant!



linx100
Euston post with full height guardrail & V4 infill



linx200
Knightsbridge post with 3/4 height guardrail



linx300
Hale knee-rail



linx200
Ashton knee-rail



linx300
Euston post with 2-rail

linx patented bracket connections



100 series **200 series** **300 series**



The Linx range comprises **3 basic series**, based on different post and horizontal bar sections and sizes. In each series the post can be fitted with a **choice of top caps and collars** that enable countless decorative combinations.

The **modular design** also allows clients to keep a ready stock of spare panels for instant replacement should any of the railing system become damaged.

linx cast cap variations



linx Euston cap



linx Ashton cap



linx Hale cap



linx Trafford cap



linx Knightsbridge cap

linxRAILING™ installation

The following images are taken from a workshop demonstration of the step-by-step assembly sequence for the Linx 100 series patented bracket connection, showing how variable angles and heights can be achieved with standard posts and panels, and therefore how standard components can be used for virtually all sites.



The complete video from which these stills have been taken is available on CD-ROM.

Please contact a member of Funitubes sales team to request a free copy.

* Note: the post shown here is a Linx 100 Visi-post (with sight gap) which requires all brackets to be bolted to the post on site in order to adjust the precise rotation of the post's cut-out gap section.

The rotation angle of non-Visi-posts (without gap) is not important, and brackets are supplied pre-fixed on one side of the post.



The assembly kit

All brackets and fixings are supplied as standard. The only specialist item required is the rivnut tool, which is available from Funitubes at a nominal price.



Marking the brackets

When the height and angle of the railing has been determined, hole centres for the fixing brackets are marked and centre punched.



Drilling the post

A 12mm diameter hole is drilled through the wall of the post at the marked positions.



The rivnut

As the name suggests, a rivnut is a combination of a rivet and a nut - essentially a rivet that has an internal thread and is shown here being fitted to the rivnut tool with an M10 mandrel.



Fitting the rivnut

The rivnut is fitted to the post via the previously drilled hole and tightened by means of a spanner and rivnut tool. The rivnut now forms a threaded insert onto which a bracket can be securely attached.



Fitting the bracket

The bracket is shaped to suit the post diameter and is fastened by a simple bolt connection to the previously fixed rivnut.



The bracket

The bracket now forms a solid connection on the post. The fixing shown here will be hidden when the railing panel is attached.



Offering up the railings

The railing panel, or individual rail is loosely attached to the bracket by the supplied fixings until final adjustment is made.



Securing the railings

A small degree of lateral adjustment is achieved by means of the slot in the bracket. Once in the correct position, fixings are tightened so the post and panel or rail form a combined solid structure.



The next panel...

The bracket is positioned on the post at an angle and height to suit the position of the next post in the line of railings and the assembly sequence as described above is repeated.



The CD-ROM also contains additional footage of the Linx 100 series during site assembly and of a number of completed installations.



More products in the Linx range!
The Linx bollards and Linx cycle stands have been designed to work with the Linx railing system, enabling co-ordination within a street scheme. Please call sales for further information.

All designs incorporating the Linx railing system, with or without surface decoration, are protected by PATENT No. 2310441 Copyright/ Design Right.

linxRAILING™ the options

linx100series

Configurations:

- Full guardrail
- 3/4 guardrail
- Knee-rail

Post:

- Ø115mm
- Visipost option

Panel:

- 60 x 40mm rectangular rails
- V2, V4 & V8 options

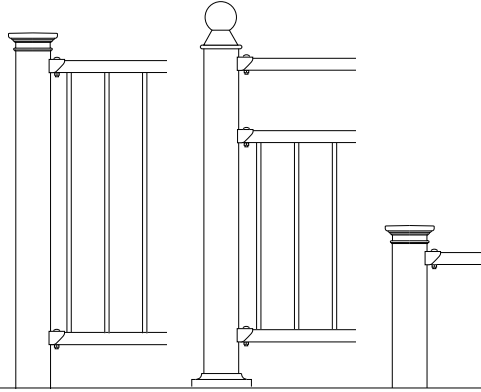
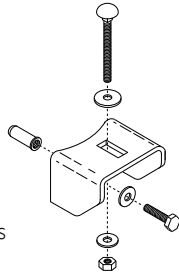

Visi-post & rail options - Tfl approved

linx200series

Configurations:

- Full guardrail
- 3/4 guardrail
- Knee-rail

Post:

- Ø76mm

Panel:

- 40 x 60mm rectangular rails

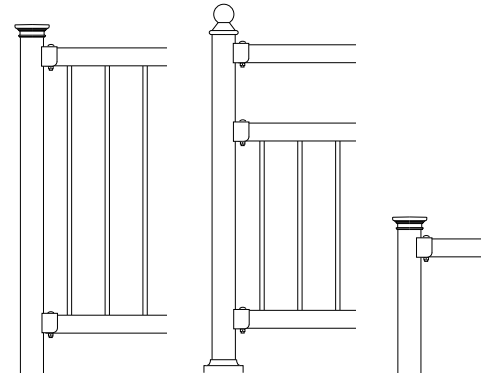
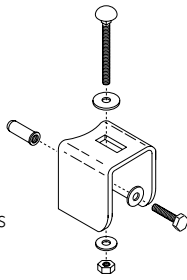

linx300series

Configurations:

- Full guardrail
- 3/4 guardrail
- 3-Rail
- 2-Rail
- Knee-rail

Post:

- Ø115mm

Panel:

- Ø48mm circular rails

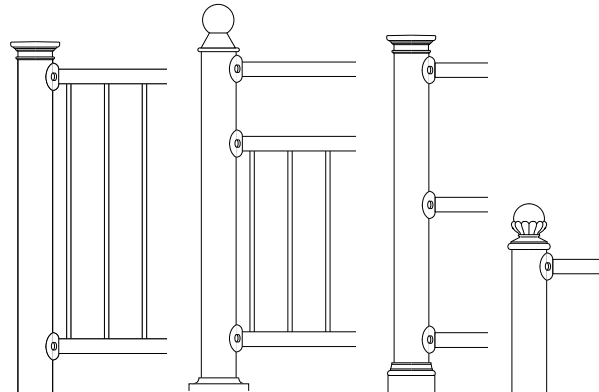
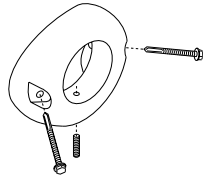

The three basic Linx series designs share common post caps and collars but differ in material sections and sizes.

Only a few of the many possible combinations are shown here. The full range is listed, complete with product codes, in Furnitubes 272 page brochure. Please contact a member of our sales team to request a copy.

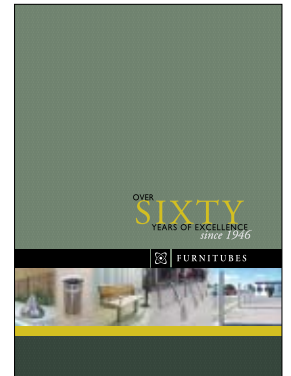

linxRAILING™ custom variations



linx100

Kenton stainless steel cap with etched logo



linx200

stainless steel cap (special commission)



linx300

Ashton stainless steel cap



linx100

Used in conjunction with BELL 115 cast iron bollard

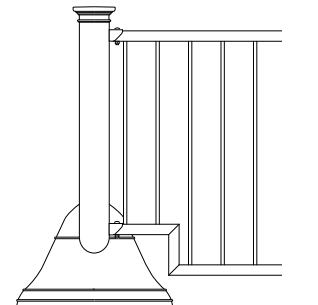

visit our website...

www.furnitubes.com

Furnitubes International Ltd
Meridian House
Royal Hill, Greenwich
London SE10 8RD
tel: +44 (0)20 8378 3200
fax: +44 (0)20 8378 3250
e-mail: sales@furnitubes.com



FURNITUBES